

GORDON STREET  
WATER & SEWER 14" ST R/W

N 79-45E →

444.5'

Note: Improvements on this lot are not in a flood hazard area.

AUG 20 1 24 PM '80  
DONNIE S. TANKERSLEY  
R.M.C.

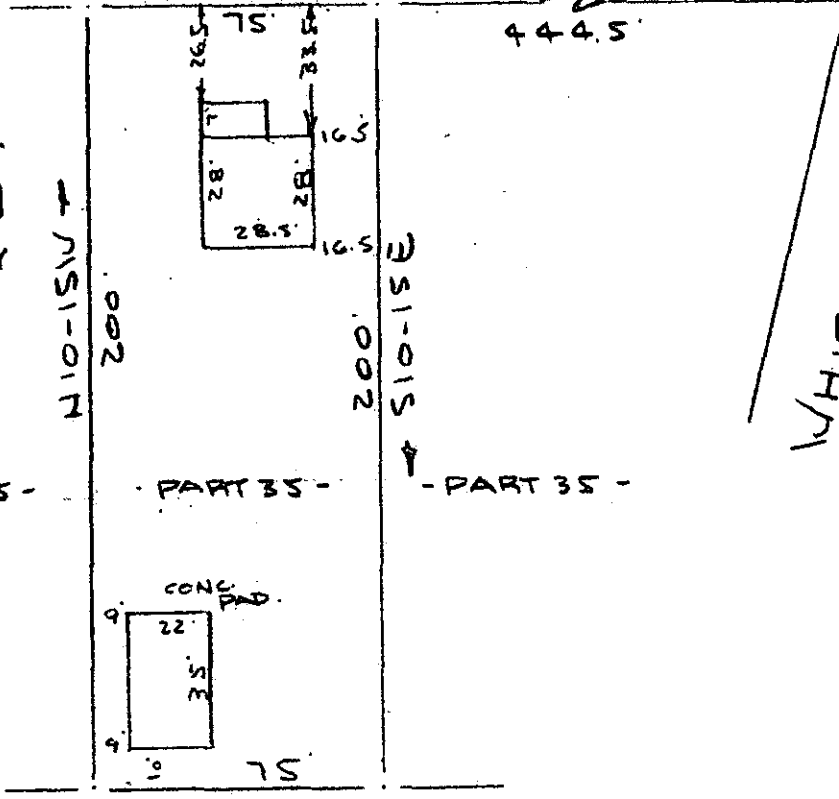

WHITE HORSE RD.  
MAG

- PART 35 -

→ S 79-45W  
- JOHNSON -

PROPERTY OF

WALTER STANLEY POWELL & AVA MADILINE POWELL  
NEAR GREENVILLE, S.C.

SCALE: 1" = 50' 19 AUG 1980

3070  
1 AUG 20 1980  
224

This is to certify that on the 19th day of August, 1980, I surveyed the property shown on this plat, being known as part of lot 35 on plat of PART OF EARLE SUBDIVISION PROPERTY OF LOOPER & YOUNG and recorded in the RMC Office Greenville County, S. C., in Plat Book " F " at Page 77 and also known as PROPERTY OF WALTER STANLEY POWELL & AVA MADILINE POWELL and recorded in Plat Book at Page and that the property lines, walls and buildings are as shown hereon, and that the walls and buildings located on said lot do not encroach or project on adjacent street or property, and that no adjacent walls or buildings encroach or project on said premises, and no power lines cross this property except as shown hereon.

5176

✓ 8-D-50

AUG 20 1980

R. B. Bruce

R. B. Bruce, R.L.S. #1972

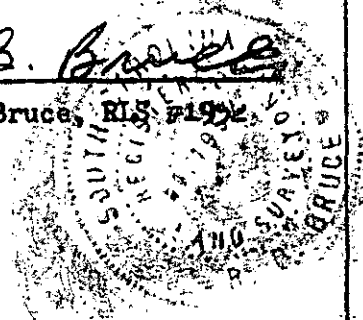

CAROLINA SURVEYING CO.  
112 Manly St.  
Greenville, S. C.

3.0001